

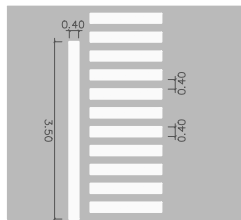

Piso podo tátil indicação de alerta

PERSPECTIVA
RAMPAS P/ CADEIRANTES
Inclinação máxima 8,33% ou 1:12
DETALHE 1

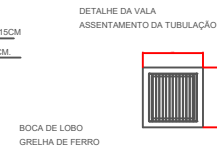
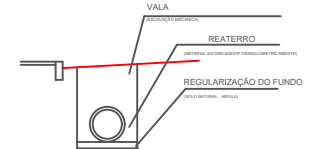
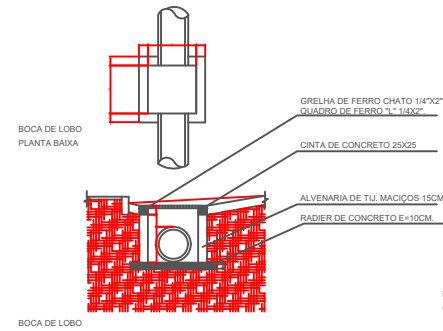

DETALHE ' - Pintura da Faixa de Pedestre

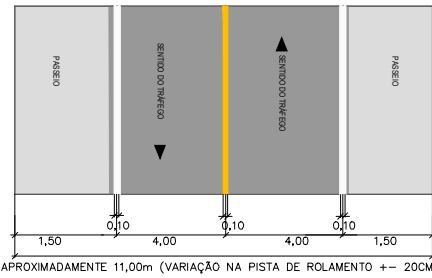

APROXIMADAMENTE 11,00m (VARIAÇÃO NA PISTA DE ROLAMENTO +- 20CM)

DETALHE - ESPAÇAMENTOS ENTRE FAIXAS

Tinta: HOT SPRAY
Cor: BRANCA E AMARELA

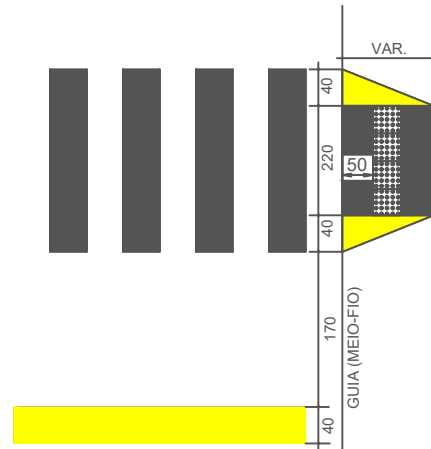

FAIXA DE SEGURANÇA
DETALHE 1
PLANTA BAIXA

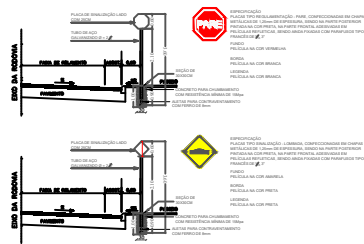
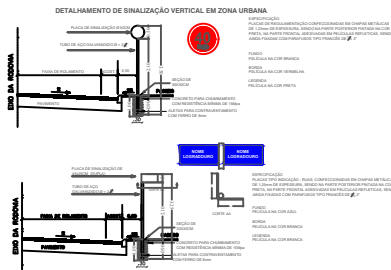

RUA VALZUMIRO DUTRA, 161-CENTRO-CEP 98.460-000
FONE (55) 3745-1288 - IRAÍ/RS

IRAÍ/RS		DETALHES	
PAVIMENTAÇÃO ASFÁLTICA (CBUQ)	PRANCHAS: 03/04	DATA: 03/03/2022	
PROFUNDIDADE: 50CM	ESCALA: INDICADAS	REV. TOTAL: 2/03/1/2021	
MATEUS ANTUNES DA SILVA		ANTÔNIO VILSON BERNARDI	
<small>Projeto Arquiteto Responsável: Antônio Vilson Bernardi, CRP 108/RS de 04/04/2004 e Registro 000000 000/171</small>			