

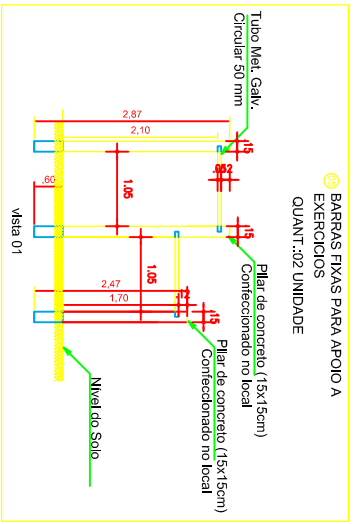

DETAANHAMENTO DOS APARELHOS DA
ACADEMIA DE SAUDE

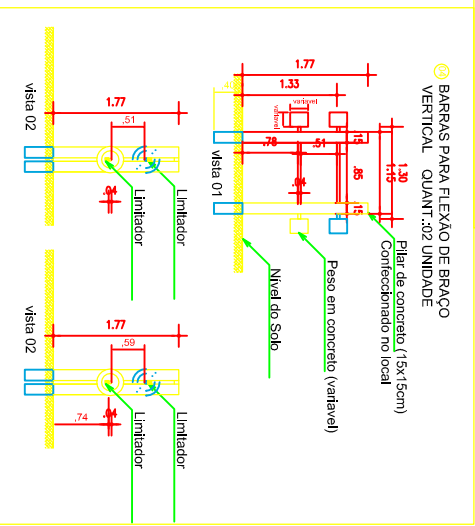
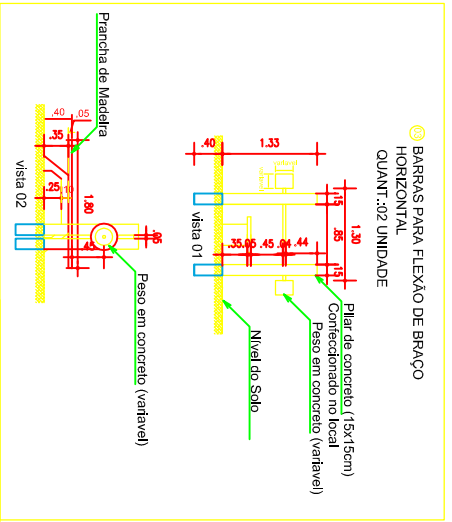
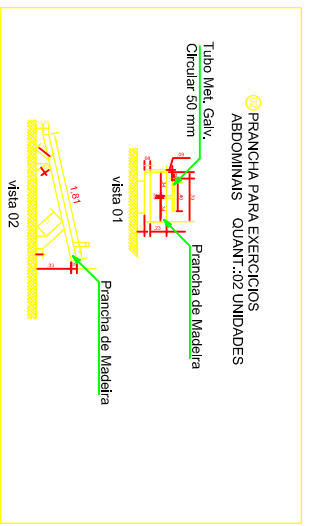
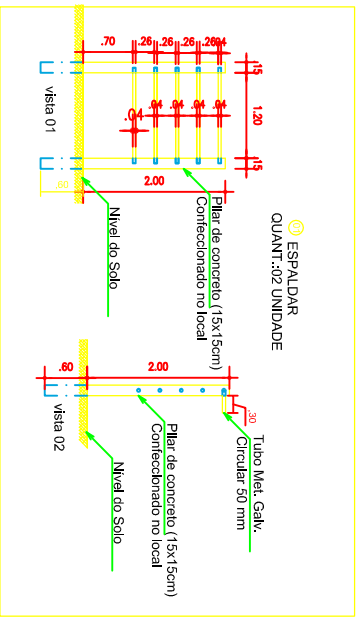

				
POLO DA ACADEMIA DA SAUDE				
<small>Rua do Comércio, 16-17 - Botafogo - RJ - CEP: 22250-900 - Fone: 2508-5700 - 119</small>				
PROJETADA POR	ARQUITETONICO	APARELHOS P/ ACADEMIA	ASSISTENTE	ASSISTENTE
ANIEL ANSSEN	ANSSEN	ANSSEN	GOVANI	ZERUSSO
PROFESSORA	PROFESSOR	PROFESSOR	PROFESSOR	PROFESSOR
115,32m ²	1/50	MAIO/2012	04	